

How-to Download a Parcel Report using the Monterey County Basemap

- Go to Monterey County RMA's GIS website [here](#). Click on Monterey County Basemap.  [Monterey County Basemap](#)

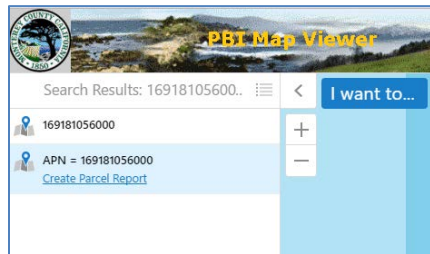

- Download Parcel Report using Parcel Search:
 - In the Search Bar, type Assessor's Parcel Number (APN) WITHOUT dashes. Hit enter.
 - To **Zoom to Parcel**, click on the "Blue" highlighted parcel in the Results Column.



- To **Download Parcel Report**, click [Create Parcel Report](#).

- Download Parcel Report using Address Search:

- In the Search Bar, type address.
- To **Zoom to Address**, click on the blue highlighted address in the Results Column.

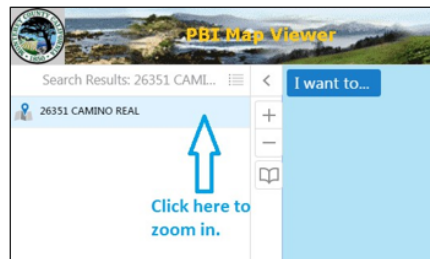

- Click [I want to...](#). Then click  **Find data on the map**. Then drag a rectangle around the address and property to find data at the location.

Find data on the map
Click, tap, or draw a rectangle on the map to identify features.

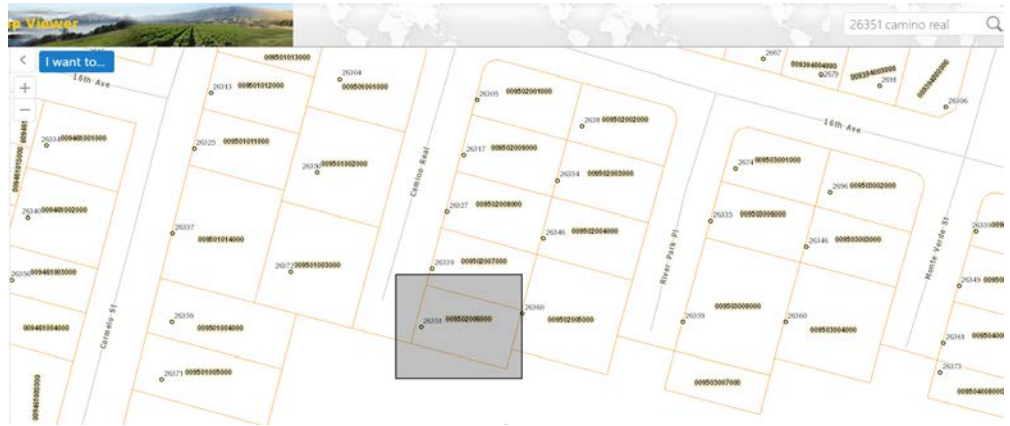

D. Results for the selection are shown in the Results Column. To **Download Parcel Report**, click [Create Parcel Report](#).

PBT Map Viewer

Identify Results (12) I want to...

	26351 CAMINO REAL
	APN = 009502007000 Create Parcel Report
	APN = 009491001000 Create Parcel Report
	APN = 009502005000 Create Parcel Report
	APN = 009502006000 Create Parcel Report
	MONTEREY CO
	26351 CAMINO REAL
	009502007000
	009491001000
	009502005000
	009502006000
	MONTEREY CO

Displaying 1 - 12 (Total: 12)

Page 1 of 1