



Moss Landing Marine Laboratories

8272 Moss Landing Road, Moss Landing, CA 95039-9647 USA Tel: (831) 771-4400 Fax: 632-4403

(<http://www.mlml.calstate.edu>)

Moss Landing Marine Laboratories
Draft Development Plan
January, 2008

The Moss Landing Marine Laboratories (MLML) are the graduate program and research facilities serving seven California State Universities campuses located in Fresno, Stanislaus, Sacramento, San Francisco, Hayward, San Jose and Monterey Bay. The second oldest marine lab on the Monterey Bay, MLML is the only graduate program in Marine Science in the California State University and serves as the gateway to the Monterey Bay National Marine Sanctuary for Staff, Faculty and Students of the CSU, affiliated researchers and the public. Since its grass-roots inception in 1966 in a converted cannery building, MLML has built a program in graduate education and research that is internationally renowned for excellence in the disciplines of marine science.

Among the marine institutions around the Bay, MLML distinguishes itself by engaging in a broad spectrum of coastal and marine research topics, often applied to questions of the whole organism or ecosystem and their responses to anthropogenic impacts and mitigation. Utilizing the coastal campuses of the CSU, MLML has recently established a coastal observatory, spanning all of California and dedicated to monitor environmental conditions and change in the coastal zone. In addition, MLML operates the largest fleet of research vessels in central California including the R/V Point Sur, a 500 ton, 135 foot regional class research vessel, owned by the National Science Foundation. Over the last 40 years, MLML has acquired several properties in support of these activities and programs. Several recent developments now compel a comprehensive plan that will incorporate all the needs of the institution and more formally develop the uses and facilities at each one of these properties. In addition, MLML recognizes the opportunity to functionally and programmatically address and demonstrate issues of sustainability in the coastal zone.

In this document we present draft conceptual plans for the development of 1) a combined Marine Operations, Research Diving and Sustainable Fishery Offloading Facility; 2) Modifications to existing facilities at our northern Shore Laboratory Complex, 3) a southern Shore Laboratory complex that combines a research pier/coastal observatory, large animal holding tanks, lab space and an integrated aquaculture research facility; and 4) housing and visitor-serving facilities for the accommodations of students during the academic year and workshops, classes and special programs during the summer. This latter project will also incorporate an additional wing to our main laboratory for the establishment of a center for Sustainable Ocean Sciences (SOS), associated office and meeting facilities.

With this document, we seek to articulate our vision for the MLML properties, show how they are key to our functionality, and will serve the needs of the local and regional (as well as national) communities in a way that is consistent with the concepts and ethics of sustainability. We also seek input from regional agencies and local businesses to insure that this plan is well integrated into the fabric of North Monterey County.

- A) MLML Main Campus
- B) Sandholdt Center
- C) MLML Shore Laboratory/Pier
Aquaculture Facilities
- D) MBARI
- E) MLML Norte Laboratories
- F) MLML Del Mar Facility
- G) MLML Small Boats/Research
Diving
- H) Santa Cruz Cannery Bldg.
- I) MBARI Proposed



COMMUNITY OF
MOSS LANDING

Schwarz & Wessner
ARCHITECTS AND PLANNERS
1000 AVENUE OF THE STARS
SUITE 1000
LA JOLLA, CA 92037
TEL: 858.592.1234

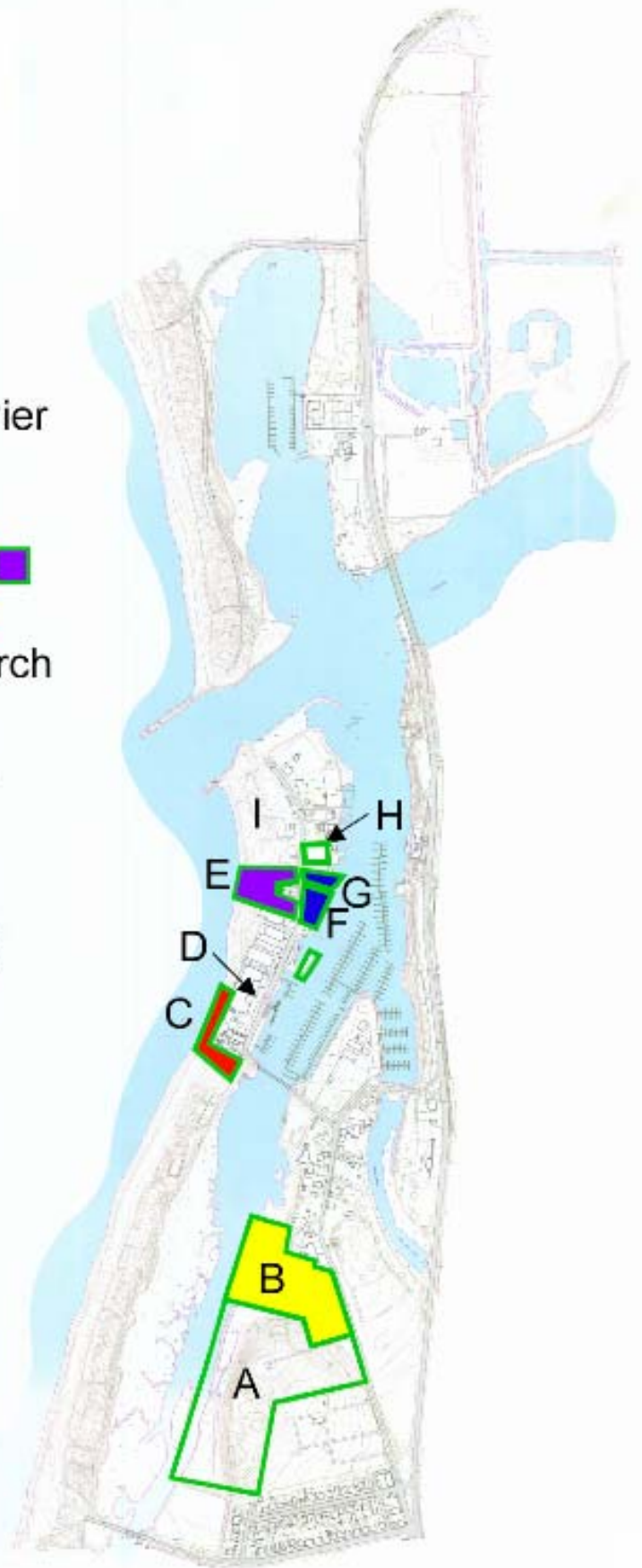

Marine Operations/Scientific Diving/Sustainable Fisheries Facility

This project seeks to integrate several ongoing MLML marine operational functionalities while increasing public awareness, promoting sustainable fisheries and saving jobs in Moss Landing.

This development will involve a series of adjacent parcels, located on the east (Harbor) side of Sandholdt Road (7544, 7539) including both the current MLML Small Boats and Scientific Diving facilities, boat yard, docks (0.5 acres) and the former Del Mar docks and offloading facilities, now being leased back to Del Mar Seafoods.

The proposed development would retain the functionality of both parcels yet add berthing for the NSF Regional Class Research Vessel, now being planned to replace the R/V Point Sur as well as other state or federal vessels. Extensive demolition and remodeling of the existing facilities and reconstruction of the docks/seawall, would be required together with the construction of a new combined Marine Operations building. The resultant integrated facility would have 350 feet of dock space a two story 26,000 sq. ft. building that would provide work, warehouse and shop space in support of marine operations, mobilization and demobilization of scientific expeditions, caretaker quarters, office and meeting space for both MLML marine operations staff and MLML Small Boats and Diving staff. It would include compressor, fill station, storage banks, nitrox system, and dive lockers and showers to support ~30-40 ML divers. The Integrated Sustainable Fisheries building would require about 10,000 sq. ft. (two stories) for vessel offloading, fish pumps, scales, conveyors, forklifts, bins and de-watering equipment, ice machine and a HGT machine with packaging, and a public viewing area. A business plan and feasibility study is now being prepared for this project and the Coastal Pelagic Species (sardines, anchovy, squid), specifically addressing the conversion of the current large volume/low value crop to a lower volume/higher value crop. Large truck access to both facilities is necessary. Port-side vessel support also requires the use of forklifts and cranes. Small boat docks are required for a minimum of four 30-60' vessels, three 20' whalers, three inflatables It also includes a launch ramp for small vessels (<35').

Purpose: research support, education, fisheries

Use: staging oceanographic research cruises, boating and diving research operations, education, sustainable fishery operations.

Square footage: 36,000 sq. ft. of mixed use buildings (warehouse, offices, shops, offloading facilities, 15,000 sq. ft. of dock/wharf area, parking for 30

Number of Occupants: 20

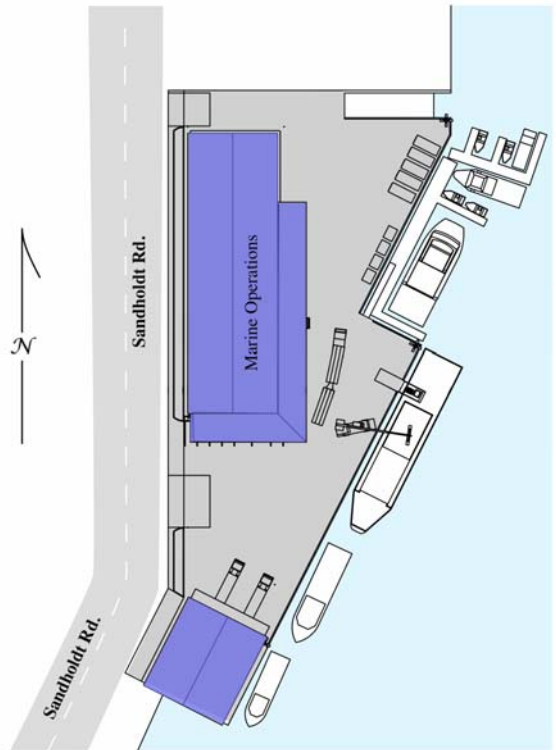
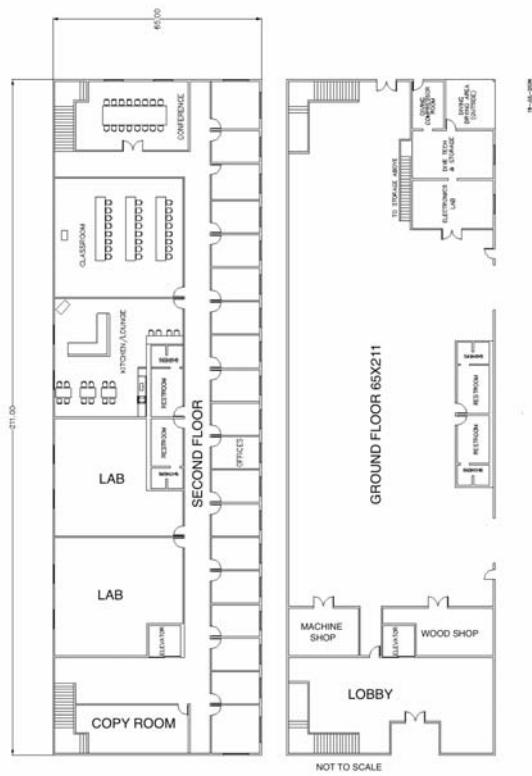

Marine Operations/Scientific Diving/Sustainable Fisheries Facility

Shore Laboratories (Northern Complex) 7544 Sandholdt Road

Remodel of existing deck into enclosed office space (600 square feet) and installation of a steel building (2000 square feet) will provide accommodations for the MLML Marine Operations group.

The “Norte” Complex is home to the Marine Pollution Studies Laboratories, Environmental Biotechnology Laboratories, Sea Lion Research/Training Facilities and the Center for Habitat Studies. This complex provides research space for students, and staff, together with laydown area and storage for boats and trailers used in support of a variety of field sampling programs including the Department of Fish and Game’s Musselwatch program, the State’s Surface Water Ambient Monitoring Program (SWAMP) and the state funded Invasive Species program.

This project seeks to consolidate the functionality of the Marine Operations group through the development of facilities for their accommodation now and throughout the construction of the new facilities. With the compression of the MBARI spaces, the MLML Marine Operations Group was forced to move out of the MBARI building D. We currently rent space in the Harbor District owned Santa Cruz Cannery Building (7532 Sandholdt Road). Consolidation of facilities would save MLML an estimated \$45,000 per year.

Proposed is the remodel/enclosure of a second-floor observation/deck area overlying the front of the building, now accommodating first floor offices and meeting spaces, estimated to be about 600 square feet. This would be for Marine Operations staff, overseeing the operations of both the R/V Point Sur and the Small Boats department. In addition, about 2000 square feet of space, secured from weather and theft, is required for cruise mobilization and demobilization to accommodate researchers using the R/V Point Sur. These users ship equipment, supplies and materials from all over the country and a protected area is required to effectively stage for deployment. This area would also be used to store equipment used on the R/V Point Sur and other research vessels including refrigerated laboratories, sediment coring equipment, nets, inflatable boats, whalers, trailers and mooring equipment.

Purpose: research support

Use: staging oceanographic research cruises, boating and diving research operations.

Square footage: 600 and 2000 sq. ft. of mixed use offices and warehouse facilities

Number of Occupants: 6 additional

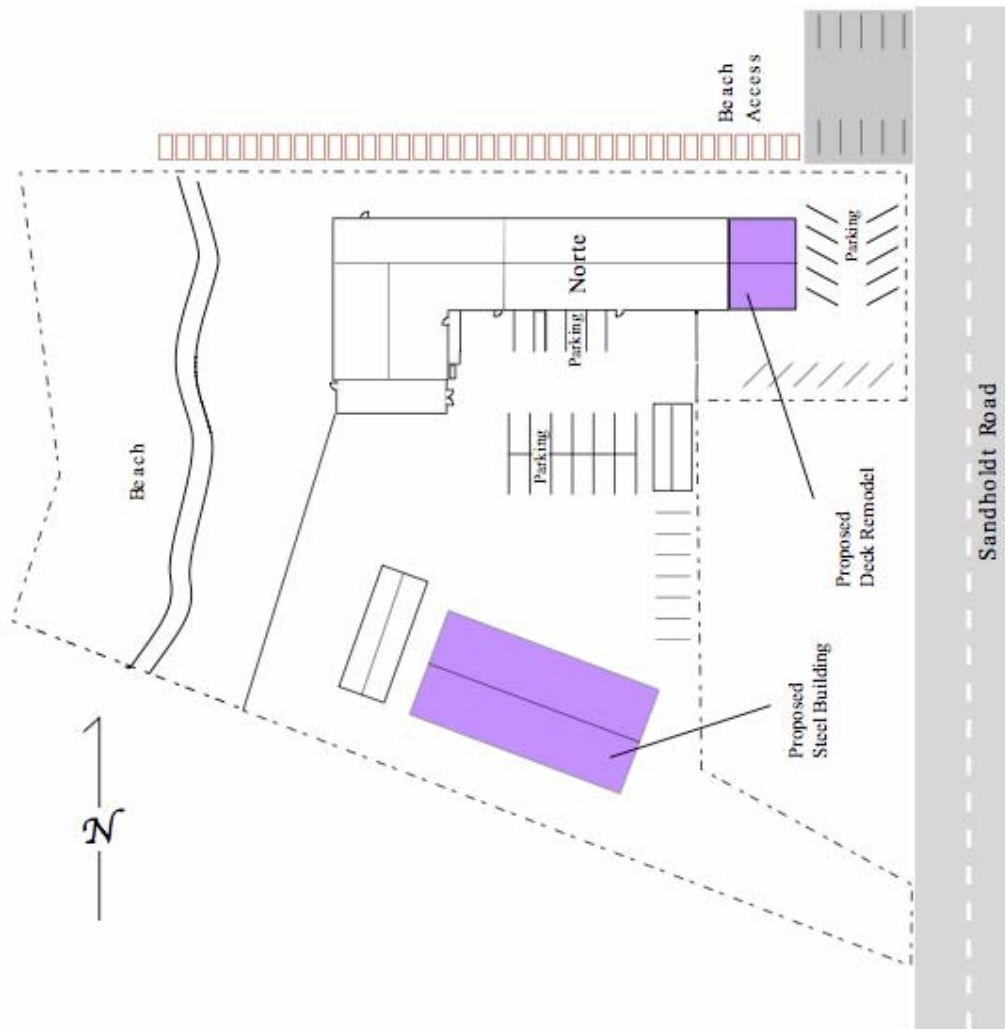

Shore Laboratory Complex, Norte



Shore Laboratory/Research Pier Facility (Southern Complex) 7722 Sandholdt Road

This project seeks to regain much of the shoreside/pier research and culturing functionality lost to the labs following the 1989 Loma Prieta Earthquake. The activities at this facility are intimately coastal-dependent and cannot be reproduced elsewhere.

The parcel located on the west (Bay) side of Sandholdt Rd. (7722) is the site of a portion of the original MLML facility and pier that presently has a pump house, aquaculture building, and an office trailer. The proposed development would reconstruct six facilities/functionalities at this site: an integrated aquaculture facility, an outdoor aquaculture/aquarium facility, a large animal husbandry/research facility, an indoor seawater research lab, caretaker quarters, and a pier. The integrated aquaculture facility would be composed of a one-story 1,079 sq. ft. building that would provide laboratory space for processing specimens from the outdoor tanks. The laboratory building, caretaker quarters included, would have an office space, an analytical chemistry laboratory, and a culture and microscope room.

Outside of this building would be a concrete slab that would have 9-10, 500 gallon tanks that would allow the culture of seaweeds and invertebrates in an integrated system to initially test hypotheses regarding husbandry, integration, quality, and growth rates of algae and abalone grown in combination. The other outdoor aquaculture facility is a 2,160 sq. ft. concrete slab with 8-10, 500 to 3,000 gallon round tanks that will allow the culturing/holding of algae, invertebrates, and small fishes. This facility would have the capability of being covered but would not have walls. The large animal facility would be a series of 5-6 six large 2,000 to 10,000 gallon concrete or fiberglass tanks (perhaps 6-20' in diameter) with a connected trex-planking walkway joining the tops of the tanks and a centrally-located food preparation room (200 sq. ft.). This facility would be used to hold large vertebrates such as sharks, birds, and mammals. The indoor seawater research lab would be a 2-story building (4,000 sq. ft.) with a large open room (3,500 sq. ft.) that is open from the floor to ceiling taking up the bulk of the space with one side of the building a laboratory, a small meeting area on the bottom floor (500 sq. ft.) and an office space and caretakers lodging on the top floor (500 sq. ft.).

At the seaward side of the property would be a 22' wide, 500' long pier with a 175 sq. ft. sieve house, and a 35' by 35' turnaround at the end of the pier. This pier would be used to convey our seaward system through the intertidal, provide locations for automatic environmental monitoring and sampling, allow vessel tie-up for personnel and equipment transfers, allow docking for autonomous underwater vehicles (AUVs) used by MBARI, provide access to nearshore waters for scientific and class sampling, and provide limited public access. The pier is already permitted, but we are looking at the feasibility of including wave power generation as part of this structure.

Purpose: Aquaculture, husbandry, holding, research, and education

Use: Aquaculture and holding for algae, invertebrates, fishes, birds, and mammals, and provide public and scientist access to the nearshore environment via the pier.

Square footage: 7,400 sq. ft. of buildings, 8,510 sq. ft. of concrete slabs, 20' wide roadway, and 300' pier.

Number of Occupants: 8-10, Parking Places: 18

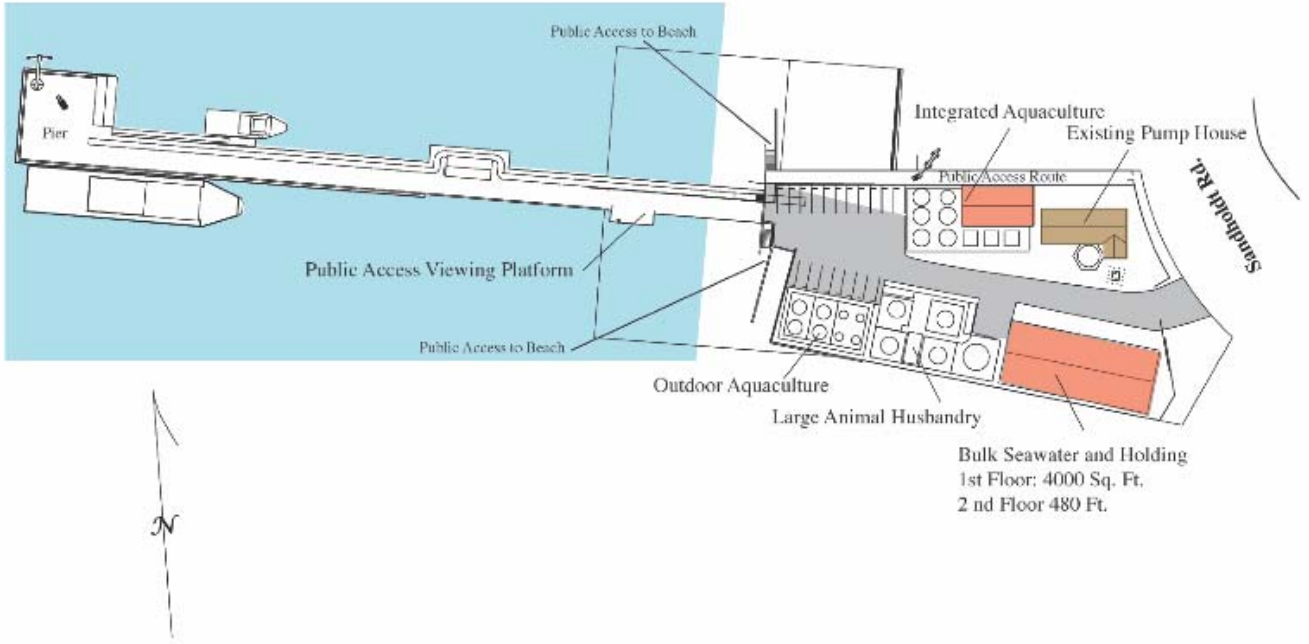

Sandholdt Center, Academic Village

This project involves the construction of a housing, office and conference complex at the Sandholdt Center, a 9-acre parcel immediately adjacent to the main Laboratory facilities at 8222 Moss Landing Road. By housing students and workshop participants on site, it is estimated to reduce traffic on Highway 1 by about 60 trips per day and be a model for green development.

There is a need for scientists, resource managers and business groups to work together to define problems of mutual interest and societal importance. MLML has recently established (and trademarked) the Center for Sustainable Ocean Science (SOS). Using a series of workshops and summer programs, the Center will bring these stakeholder groups together in order to frame the issues, define the problems and seek scientific direction towards their solution. These include topics such as invasive species, harmful algal blooms, integrated aquaculture, sustainable fisheries, etc... for which there is a lack of scientific data to recommend a proactive course of action. The SOS Center will be modeled after the National Center for Ecological Analysis and Synthesis (NCEASS) at UC Santa Barbara. The outcomes will take the form of papers, joint proposals and research directions that will translate to demonstration projects. In phase one of the development plan, this will consist of the development of visitor-serving facilities in the location of the Sandholdt Center and integrated into the academic village to be developed there. Center staff will help to develop workshops (NCEAS-style) for determining which issues to address and determine likely avenues for research. The Center's workshop functions will initially be conducted during the summer months and include academic, industrial, governmental participants who will be accommodated in housing and conference facilities, planned to be part of the SOS Center.

Academic Village: Located at the Sandholdt Center, adjacent to the Main Laboratory, a 60 bed complex with apartments for the housing of graduate students during the academic year and the SOS Center participants during the summer, will be constructed to serve several needs: 1) rental income to help support program, 2) needed housing for visiting scientists, students and visitors attending SOS workshops, 3) test/training pool to accommodate the scientific diving program and the need to test equipment under controlled conditions and provide recreation for tenants of the SOS Center when not being used for teaching or research.

The facilities of the Center will be constructed to a LEED Gold or Platinum Standard and the grounds will be landscaped to blend with the habitat restoration on the adjacent MLML parcel. Wetland enhancement will be coordinated with North Monterey County Public Works in order to take advantage of storm runoff and divert surface waters from Moro Cojo Slough.

Purpose: Residential Housing, Offices, Conference and Multiple Use Facilities

Use: Provide housing for graduate students during the academic year, accommodation of programs and workshops during the summer.

Square footage: 30,000

Number of Occupants: 70

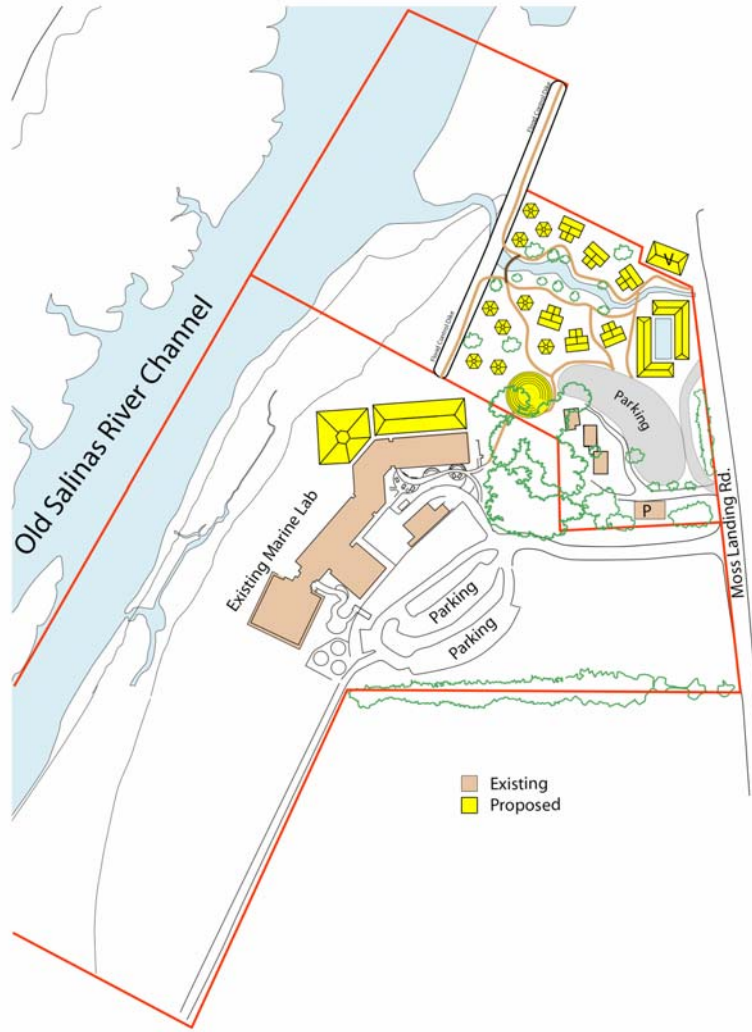

Sanholdt Center

Short Term and Long Term Project Phasing, Integration with MBARI

The above descriptions outline a series of projects, linked together through our research programs and educational needs. They are coherent and integrated. The execution of these projects, and some minor remodels, however, have independent timelines. We also seek input regarding the following phasing of the projects.

Short term needs:

- 1) Remodeling of aquaculture facilities/construction of outdoor tank area at the southern Shore Laboratory Facility, 7722 Sandholdt Road. This is required for ongoing and anticipated research. Additional research to commence in June.
- 2) Remodeling of upper-level deck area at the northern Shore Laboratory Complex 7544 Sandholdt Road to accommodate Marine Operations offices. No increase of building footprint would be needed to enclose 600 square feet of existing deck area. We are seeking funding for this project, to be started in October, 2008.
- 3) Placement of steel building at 7544 Sandholdt Road for research cruise mobilization/demobilization. This would allow for cruise support and storage of materials now located on the Del Mar and Small Boats properties.

Longer-term projects:

- 1) Development of the Integrated Marine Operations/Fishery Complex, 7539, 7544 Sandholdt Road.
- 2) Construction of research pier and remaining support facilities at the southern Shore Laboratory Complex, 7722 Sandholdt Road.
- 3) Development of the Sandholdt Center and SOS facilities, 8222 Moss Landing Road.

Integration with MBARI

Space in Moss Landing is becoming increasingly limited. Any development requires integration with other uses and capacity studies with an eye towards the long term community goals. These goals have been articulated in the general plan and the community plan for Moss Landing. As a 42 year resident of Moss Landing, MLML is undertaking this process to gather feedback from the stakeholders such that an appropriate integration of our institutional resources will result. MLML has had a productive and collaborative relationship with MBARI since MBARI first came to Moss Landing and we have continued this relationship, keeping them informed of our plans. They have reciprocated and together we hope to provide the County with an integrated vision of development in Moss Landing as best we know it. We hope to work together to insure that Moss Landing continues to be an international powerhouse of innovation in marine science research, education and engineering, tackling problems of societal importance and ocean sustainability.

QuickTime™ and a
TIFF (Uncompressed) decompressor
are needed to see this picture.