



MONTEREY COUNTY HEALTH DEPARTMENT
ENVIRONMENTAL HEALTH BUREAU

APPLICATION FOR GRAYWATER IRRIGATION
OR DISPOSAL SYSTEM PERMIT
Monterey County Code, Chapter 15.20

Please review Chapter 15 of the California Plumbing Code
for system design requirements before completing this form.

Assessor's Parcel No. - - -000 System Description:

Site Address:

Owner's Name Phone #

Mailing Address:

Water Company: Sewer Company:
(OR INDICATE 'PRIVATE WELL' or 'SHARED WELL') (OR INDICATE 'SEPTIC SYSTEM')

Graywater system is proposed to serve:

Single Family Residential Multiple Unit / Community
List all fixtures:

Tank

Daily Graywater Flow: gallons Surge Tank Capacity: gallons
Summary of section 1502.8.1 from Chapter 15, CPC regarding Graywater Calculations:
The number of occupants of each dwelling unit shall be calculated as follows:
The estimated graywater flows of each occupant shall be calculated as follows:
Table with 2 columns: Fixture, GPD/occupant

Irrigation / Disposal Field

Topography: Flat < 30% slope >= 30% slope (Variance Required)
Description: Total square feet: Multiple Irrigation Fields: Yes No If yes, how many?
Drip line Number: Length: ft. Cover Depth: in.
Mulch basins Number: Area: ft. Cover Depth: in.
Other:

I certify that I have read and understand the California Plumbing Code Chapter 16 requirements for graywater irrigation or disposal systems. I understand that if there is a complaint investigation that verifies a violation of the applicable standards, then the property owner will be subject to cost recovery and any fines resulting from the investigation (Calif. Health & Safety Code Section 510).

Signature of Property Owner

Date

For Office Use Only
FEES: Health Permit Fee \$ Receipt Number: Date Permit Fee Received: Name:
Plans Approved By: Date Plans Approved:

Environmental Health Specialist

Address: \_\_\_\_\_

Using the graph below, indicate where on the property the graywater will be used (see sample site plan on the next page). Indicate setbacks to property lines, house and other structures, drainage ways, 30% slopes, and drinking water lines (minimums are given in Table 2 on page 7 of the Permitting Guidelines). Show street frontage and your driveway.

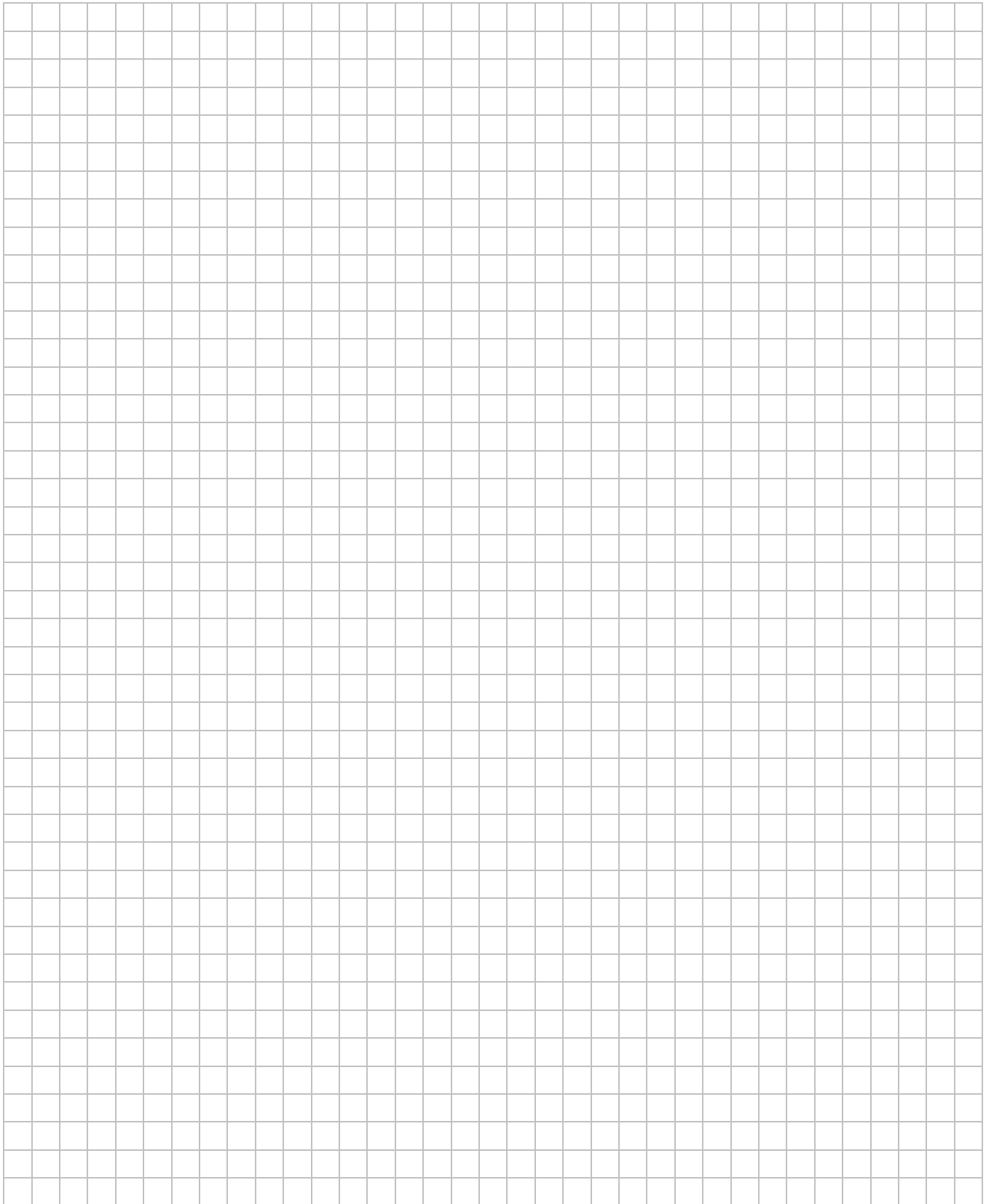

SAMPLE SITE PLAN OF GRAYWATER SYSTEM

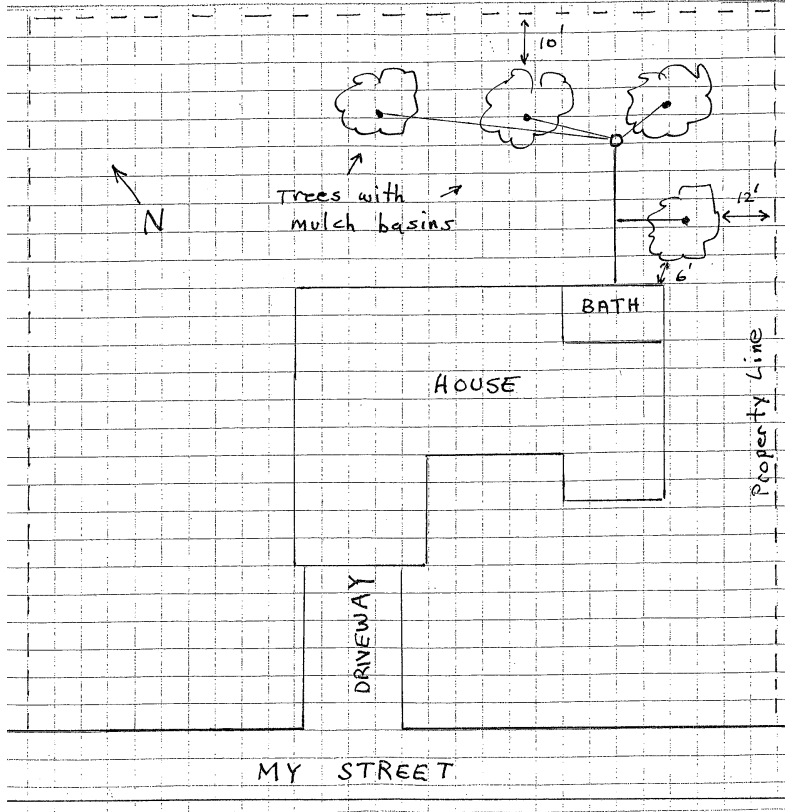

**SIMPLE GRAVITY GRAYWATER IRRIGATION SYSTEM INSTALLATION CHECKLIST**

**INDOOR FIXTURE CONNECTION**

1. BATHROOM SINK  BATHTUB  OTHER:
2. CLEARLY-MARKED 3- WAY VALVE TO DIRECT WATER FROM GRAYWATER SYSTEM TO SEWER?  YES  NO
3. ANY FRESH WATER CONNECTION TO STORAGE TANK?  YES  NO
4. DOES SYSTEM INCLUDE A PUMP?  YES  NO

COMMENTS:

**SURGE/ STORAGE TANK**

1. DOES THE SYSTEM INCLUDE A SURGE TANK?  YES  NO
2. TANK CAPACITY LESS THAN 250 GALLONS?  YES  NO
3. TANK AND IRRIGATION SYSTEM DESIGNED TO EMPTY COMPLETELY IN 24 HOURS?  YES  NO
4. TANK OVERFLOW CONNECTED TO SEWER?  YES  NO

**OUTSIDE PIPING AND SPIGOTS**

1. ARE ALL GRAYWATER PIPES AND SPIGOTS LABELLED "NON-POTABLE WATER, DO NOT DRINK ?"  YES  NO

**DISPOSAL/IRRIGATION FIELDS**

1. SLOPE OF TOPOGRAPHY?  FLAT  < 30%  > 30%
2. IRRIGATION FIELD MEETS SETBACKS TO WELLS, SEPTIC SYSTEMS, WATERCOURSES, PROPERTY LINES, AND STRUCTURES?  YES  NO
3. IRRIGATION TUBING / MULCH BASIN COVER DEPTH: \_\_\_\_\_ [MINIMUM 2"] TYPE OF COVER: \_\_\_\_\_

**OWNER'S MANUAL**

1. REQUIRED OPERATION AND MAINTENANCE MANUAL COMPLETED?  YES  NO