

READING AUTO-ANSWER MESSAGES

The auto-answer display shows the number of messages.



1. Press the **Esc** key to turn off auto-answer.



2. Press the **Y** key to read your messages.

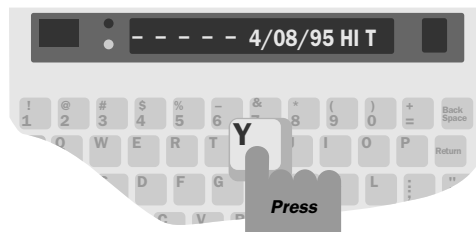

GETTING STARTED WITH YOUR SUPERPRINT 4425™

HOW TO SET UP THE SUPERPRINT 4425

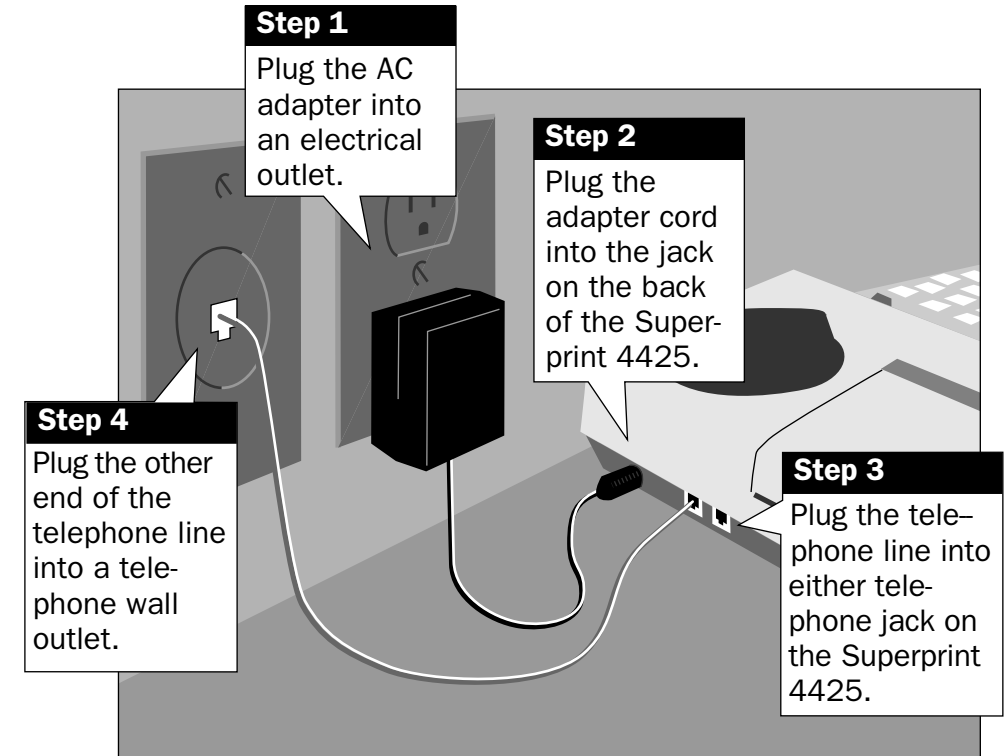

CAUTION: Plug the Superprint 4425 into a standard household telephone line. Any other line may damage your telephone or Superprint 4425 and void your warranty. For more information, see the user guide, *Using your Superprint 4425*.

This guide contains basic instructions. For complete information, see the user guide.

Ultratec, Inc.
450 Science Dr.
Madison, WI 53711
(608) 238-5400
(Voice/TTY)

MAKING A CALL

1. Turn on the Superprint 4425.



2. Hold down the **Ctrl** key and press the **1** key.

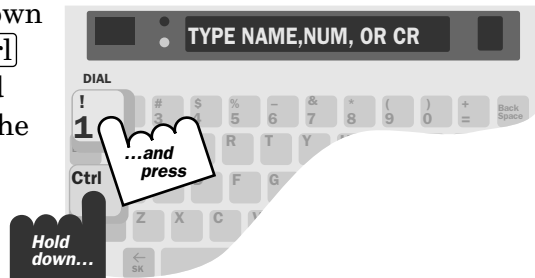

3. Type the telephone number and press the **Return** key.



4. Type a greeting when you see an answer on the display.

Turn off the Superprint 4425 when you finish your conversation.

ANSWERING A CALL

1. The signal-er flashes when the telephone rings.



2. Turn on the Superprint 4425.



3. Type a greeting and wait for an answer.



4. Turn off the Superprint 4425 when you are finished with your conversation.

TURNING ON AUTO-ANSWER

1. Hold down the **Ctrl** key and press the **+ =** key.



2. Press the **Return** key. Be sure to leave the Superprint 4425 on.



To turn off auto-answer, press the **Esc** key.